

● ● CDS-A/N

ESYLUX

www.esylux.com

GB TWILIGHT SWITCH

Congratulations on your purchase of this high-quality ESYLUX product. To ensure proper operation, please read these user instructions carefully and keep them for future reference.

1 • SAFETY INSTRUCTIONS



CAUTION: Work on the 230 V power system must be carried out by authorised personnel only with due regard to the applicable installation regulations. Switch off the power supply before installing the system.

Use this product only as intended (as described in the user instructions). Changes or modifications to the product or painting it will result in loss of warranty. You should check the device for damage immediately after unpacking it. If there is any damage, you should not install the device under any circumstances.

If you suspect that safe operation of the device cannot be guaranteed, you should turn the device off immediately and make sure that it cannot be operated unintentionally.

2 • DESCRIPTION

The ESYLUX CDS-A/N is a surface-mounted twilight switch for switching lighting systems on and off automatically (fig. 1). A built-in sensor detects the level of brightness in the surrounding area. Whenever this falls below a preset level, the CDS-A/N automatically switches the light on, switching it off again automatically when the surrounding brightness level goes back above this threshold.

3 • INSTALLATION / ASSEMBLY / CONNECTION

Before installing the product, switch off the mains supply. The CDS-A/N should only be mounted on even, vertical, north-facing surfaces (e.g. house walls). Wherever possible, the appliance should not be subjected to direct sunlight. Please also ensure that the CDS-A/N cannot be affected by the light(s) it is due to control (fig. 1).

Unscrew and take off the housing cover. With the cable guide at the bottom, mount the lower section onto the relevant surface. The cable must not be fed in until the unit is firmly in place (to ensure a waterproof connection). The switch module can be taken out to make it easier to feed in and connect the cable (fig. 5). Connect the twilight switch as per the wiring diagram (fig. 3). There is a jumper, 1.5 mm² in size, spanning from L (mains power) to L (dry contact). If you intend to use the relay contact for extra low voltage, this jumper must be taken out. Thereafter, screw the housing cover back on. The switching point is present to a practical level.

4 • GETTING STARTED AND SETTING THE SENSOR

Switch on mains power. Using the potentiometer you can now set the desired light exposure level (fig. 4). The red LED helps you to make this setting (fig. 4). When the time for the light to come on has been reached (e.g. dusk), turn the potentiometer slowly towards the "moon symbol" until the red LED lights up. The exposure level you have now set corresponds to the actual level of surrounding light and the CDS-A/N is ready for use.



NOTE: Please note that there is a delay of about 60 seconds after the LED lights up before the light connected to the sensor comes on. This switching delay of about 60 seconds stops the light switching on or off when not necessary, e.g. if the sensor is triggered by a car's lights briefly shining onto it or by a dark cloud.

5 • ESYLUX MANUFACTURER'S GUARANTEE

ESYLUX products are tested in accordance with applicable regulations and manufactured with the utmost care. The guarantor, Elektro-Technische-Systeme GmbH, Postfach 1840, D-22908 Ahrensburg, Germany (for Germany) or the relevant ESYLUX distributor in your country (visit www.esylux.com for a complete overview) provides a guarantee against manufacturing/material defects in ESYLUX devices for a period of three years from the date of manufacture.

This guarantee is independent of your legal rights with respect to the seller of the device. The guarantee does not apply to natural wear and tear, changes/interference caused by environmental factors or damage in transit, nor to damage caused as a result of failure to follow the user or maintenance instructions and/or as a result of improper installation.

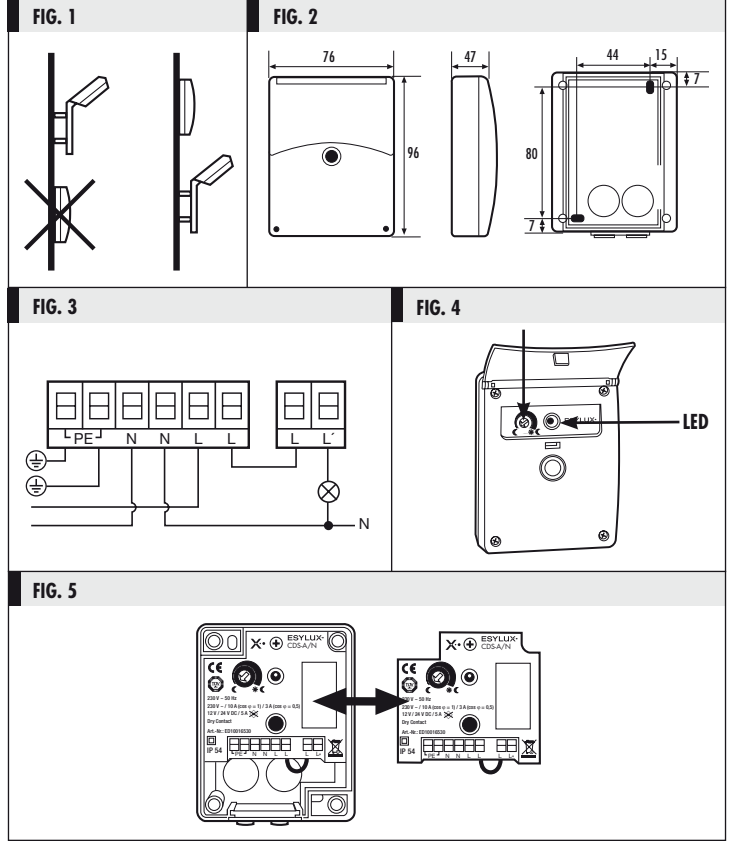

• TECHNICAL DATA

MAINS VOLTAGE	230 V ~ 50 Hz
LIGHT VALUE	approx. 5 - 300 lux
SWITCH-ON/SWITCH-OFF DELAY	approx. 60 sec
SWITCHING CAPACITY	230 V ~, 10 A (cos φ = 1), 3 A (cos φ = 0,5) 12/24 V DC/5 A, no separated extra low voltage
SWITCHING OUTPUT/SWITCH CONTACT	floating, 1 make contact
OPERATING TEMPERATURE RANGE	-25 °C...+55 °C
PROTECTION TYPE	IP 54
PROTECTION CLASS	II
TEST SYMBOL	TÜV
COLOUR	white, similar to RAL 9010, brown, similar to RAL 8017

Technical and design features may be subject to change.

Any illuminants or batteries supplied with the device are not covered by the guarantee. The guarantee can only be honoured if the device is sent back with the invoice/receipt, unchanged, packed and with sufficient postage to the guarantor, along with a brief description of the fault, as soon as a defect has been identified. If the guarantee claim proves justified, the guarantor will, within a reasonable period, either repair the device or replace it. The guarantee does not cover further claims; in particular, the guarantor will not be liable for damages resulting from the device's defectiveness. If the claim is unfounded (e.g. because the guarantee has expired or the fault is not covered by the guarantee), then the guarantor may attempt to repair the device for you for a fee, keeping costs to a minimum.

